



Discover the Unexpected

## SNOW REMOVAL REGULATIONS

**Emergency Snow Routes:** The **Emergency Snow Routes** are displayed in grey below. These routes have been determined by the City as a priority for snow removal for emergency travel. No parking is allowed at any time on the **Emergency Snow Routes** in a snow event over 2", or during an **Emergency Snow Alert**.



**Commercial Core Area:** The **Commercial Core Area** is that area of the city including and bounded by N. 2nd Street on the north, Washington Avenue on the east, S. 2nd Street on the south, and Blanche Avenue on the west. This area includes municipal parking lots and is displayed on the black outline below. It is the city's policy to blade, windrow, load and haul from this area.

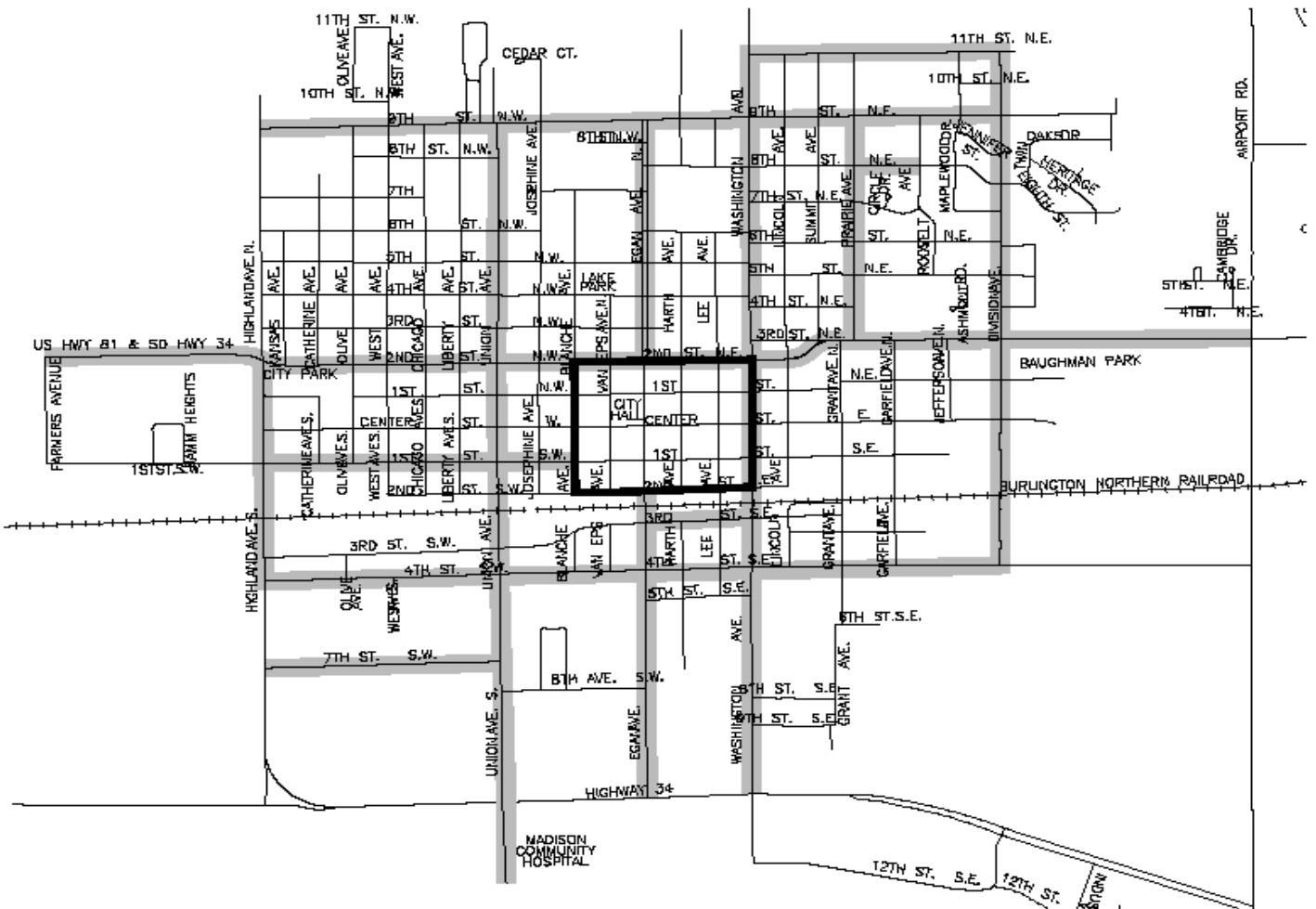

- NW 9th Street from Highland Ave to Division Avenue
- NW 2nd Street from West City Limits to Summit Avenue
- NE 3rd Street from Summit Avenue to Airport Road
- SW 1st Street from Highland Avenue to S Blanche Avenue
- SW 4th Street from Highland Avenue to Division Avenue
- Highland Ave from NW 2nd Street to SW 4th Street
- Union Avenue from NW 9th Street to S of Madison Hospital
- Egan Avenue from N 9th Street to N 2nd Street
- Egan Avenue from S 2nd Street to S 10th Street
- Washington Avenue from NE 11th Street to SE 10th Street
- Prairie Avenue from NE 9th Street to NE 3rd Street
- Division Avenue from NE 11th Street to SE 4th Street
- NE 11th Street from N Washington Avenue to N Division Avenue
- NE 8th Street from Prairie Avenue to Roosevelt Avenue
- SW 7th Street from Highland Avenue to Union Avenue
- SE 3rd Street from Egan Avenue to Washington Avenue



**PLOWING OPERATIONS WILL CONTINUE UNTIL ALL STREETS HAVE BEEN CLEARED.**



# BE INFORMED OF THE FOLLOWING CITY ORDINANCES



## SEC. 18-96. Parking of vehicles

- (a.) During an emergency snow alert, it shall be unlawful to park on designated **EMERGENCY SNOW ROUTES** for the **duration of the alert**.
- (b.) During an emergency snow alert, no person shall park, or remain to be parked, any vehicle on any public street, avenue or alley until it has been cleared curb to curb.
- (c.) During an emergency snow alert, it shall be unlawful for any person to park any vehicle in designated city owned parking lots until the lot has been cleared of snow.



**\$25.00**

## SEC. 18-97. Removal of vehicles

**\$25.00**

Vehicles parked on an emergency snow route, the commercial core area, designated city owned parking lots or on any street, avenue or alley after an emergency snow alert is declared are subject to an immediate parking ticket with a twenty-five dollar (\$25.00) fine and a twenty-four (24) hour tow warning. If the vehicle has not been moved in twenty-four (24) hours, it will be subject to towing at the owner's expense.



## SEC. 18-98. Depositing of snow



- (a.) It shall be unlawful for the owner, occupant, or operator of a business, apartments, mobile home park, parking lot or other vacant space to blade, push, plow, blow, shovel or deposit the snow from said area into the public street, avenue or alley in any manner that would hamper pedestrian or vehicle travel and/or onto a public boulevard right-of-way in any manner that could create a sight obstruction by unduly impairing visibility at any intersection or that would effectively block street signage, excluding sidewalks in the commercial core area.
- (b.) Policy shall be not to remove snow deposits left by snowplows at private driveways, mailboxes, vehicle delivery or fire hydrants. Property owners are responsible for clearing snow as deemed necessary near mailboxes and fire hydrants located in the boulevard areas.
- (c.) Policy will be to eventually return and clear and widen streets to near the curb line as much as practical after the emergency snow alert has been terminated. Widening operations may, unfortunately, produce blocked or plugged driveway conditions to property owners or tenants.

## SEC. 18-74. Snow and ice to be removed from sidewalk by property owner.

The owner of any property must remove all snow and ice from any sidewalk upon the owner's property within 48 hours after any snowfall, snow or ice accumulation so that sidewalks are clean and safe for pedestrians for safe and convenient foot travel. Snow and ice must also be removed from that portion of the sidewalk which ends at an intersection or crosswalk, including the curb ramp. The owner of property abutting sidewalks on two intersecting streets must remove all snow and ice from the sidewalks of both streets, regardless of the source of the snow accumulation. Snow and ice deposited on the sidewalk from the street snow removal process must also be removed within 48 hours of being deposited. Failure to remove snow and ice from a sidewalk in accordance with this division constitutes an ordinance violation.

In the event ice has so formed upon a sidewalk that it cannot be removed, then the owner must use sand, salt or other suitable substance in such manner as to prevent the ice from being dangerous until such time as it can be removed. Snow and ice which is removed from a sidewalk may be placed on the boulevard or yard. It is unlawful for any person to dispose of or move snow from a sidewalk or other private property onto a public street, alley or sidewalk.

All **Snow Emergency Alerts** will be posted online at [www.CityofMadisonSD.com](http://www.CityofMadisonSD.com) as well as reported to: *KJAM* and to local television channels.

Notices will also be placed on Facebook at *City of Madison-Public Works* and on Twitter *@MadisonSDPW*

For Text Notifications - text **MADISONSD** to 33222



**FOR AUTOMATED SNOW ALERT INFORMATION CALL:  
256-SNOW (7669)**

